

PROPOSED TRUCK TERMINAL FOR:
" IOV SPEC. POMPANO "
1801 NW 15TH AVE.
POMPANO BEACH, FL. 33069

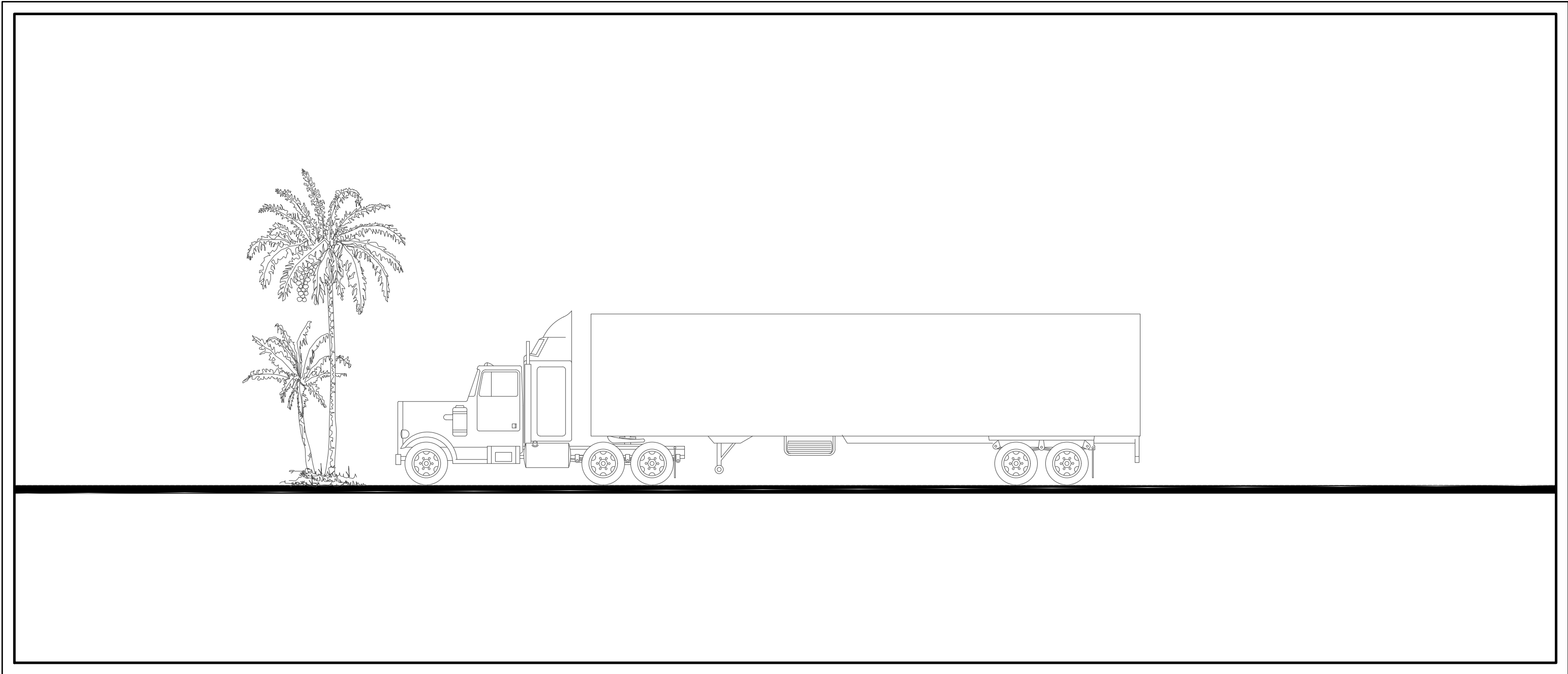
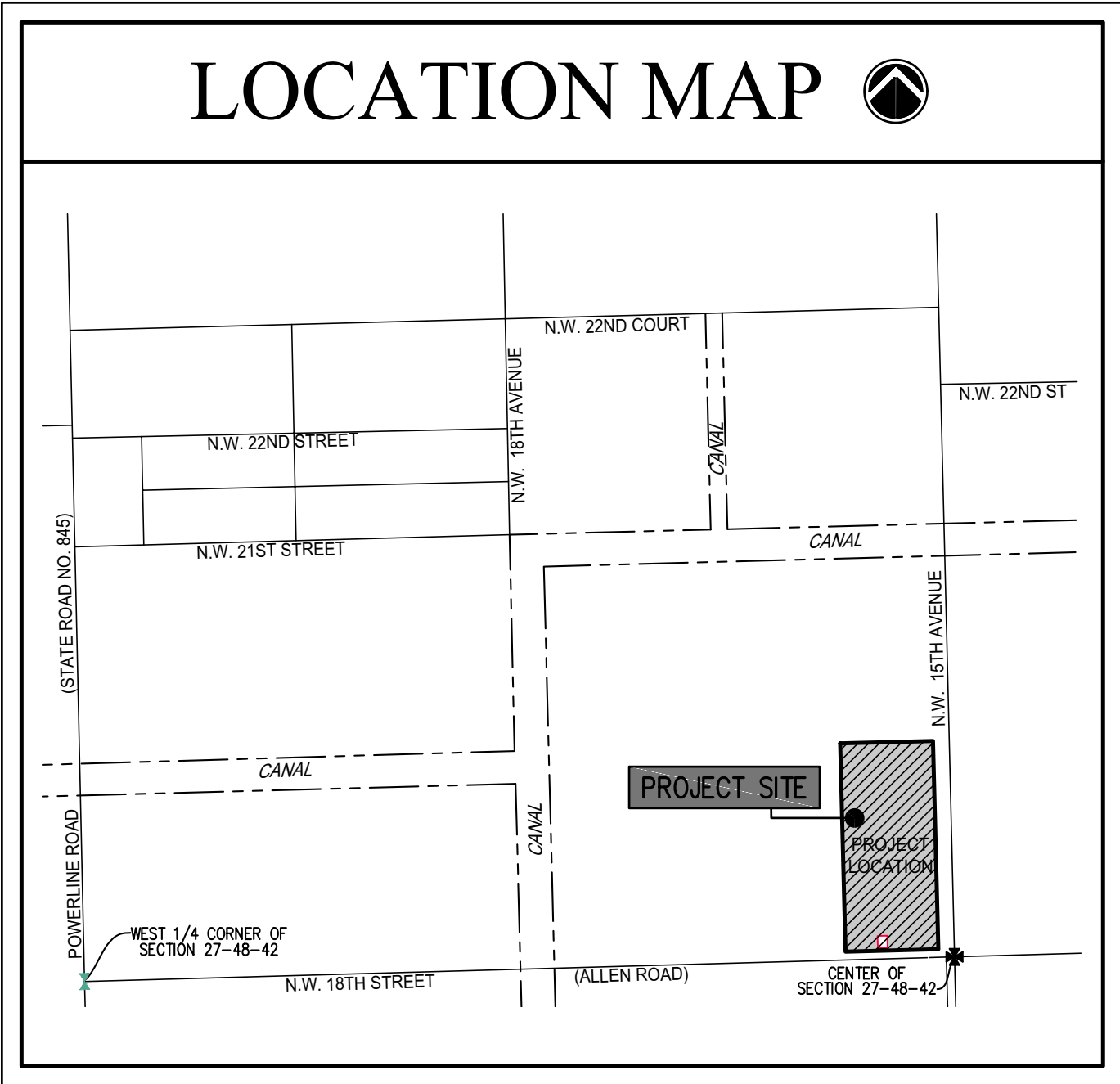

SHEET INDEX

COVER SHEET	
CS	SURVEY
SITE WORK	
SP-1	PROPOSED SITE PLAN
SP-2	SITE DATA, & DETAILS
SP-3	DUMPSTER ENCLOSURE DETAIL
SP-4	EXHIBIT #1 - LANDSCAPE AREA AND PERIMETER BUFFER YARD
SP-5	EXHIBIT #2 - LANDSCAPE AREA BETWEEN INTERIOR ABUTTING PARKING BAYS
SP-6	ENLARGED 3 POINT TURNING RADIUS
CIVIL	
C1-C2	CIVIL COVER SHEET PAVING, GRADING, AND DRAINAGE WATER AND SEWER SERVICE CONNECTIONS PLAN
C3	PAVING AND DRAINAGE DETAILS
C4	PAVING, GRADING, AND DRAINAGE SECTIONS
C5	CITY OF POMPANO BEACH - STANDARD DETAILS
C6	POLLUTION PREVENTION PLAN
LANDSCAPE	
L-1	LANDSCAPE PLAN
L-2	LANDSCAPE DETAILS
IRRIGATION	
IR-1	IRRIGATION PLAN
IR-2	IRRIGATION DETAILS
PHOTOMETRIC	
PH-1	PHOTOMETRIC PLAN
PH-2	PHOTOMETRIC LIGHT FEATURES SPECIFICATIONS
PUBLIC SAFETY SECURITY PLAN	
CPTD 1	CPTED PLAN - LIGHTS ILLUMINATION
CPTD 2	CPTED PLAN - CAMERA VIEWS

PZ #: 20-12000040

PROJECT TEAM

<p>ARCHITECT:</p> <div><p>GUSTAVO J. CARBONELL, P.A. Architect and Planner Member American Institute of Architects</p><p>1457 N.E. 4th AVE. Ft. Lauderdale, Florida, 33304 E-Mail: gcarbonell@gjcarch.com</p><p>Phone: (954) 462-6565 Fax: (954) 527-0857</p></div> <p>Maritza J. Gil Architctural Project Manager Phone: (954) 462-6565 Ext. 24 E-mail: mgil@gjcarch.com</p> <p>FLORIDA REGISTRATION AR NO. 0007957 AA NO. 26001131</p>	<p>CIVIL ENGINEER:</p> <p>JOHN B. SMITH ENGINEERS, INC</p> <p>250 SW 6th PLACE POMPANO BEACH, FL 33060</p> <p>Certificate of Auth. # 1688 P.E. - 31177 Phone: (954) 763-4177 email: johnsmith@att.net</p>	<p>LANDSCAPE ARCHITECT:</p> <p>KIMBERLY MOYER, RLA</p> <p>4808 NE 16 Avenue Oakland Park FL 33334</p> <p>LA - 0000952 Phone: (954) 492-9609 email: k.moyerla@gmail.com</p>
---	---	--

Gustavo J Carbonell
Digitally signed by Gustavo J Carbonell
Date: 2022.03.14 19:52:56 -04'00'

JOB #: 20-12000040

DRC

PZ20-12000040
4/20/2022